

# Pièces de rechange

# Spare parts list

GB19GSDPS 010446.1

GB19BSDPS 010447.1

19BS6DP 013317.1

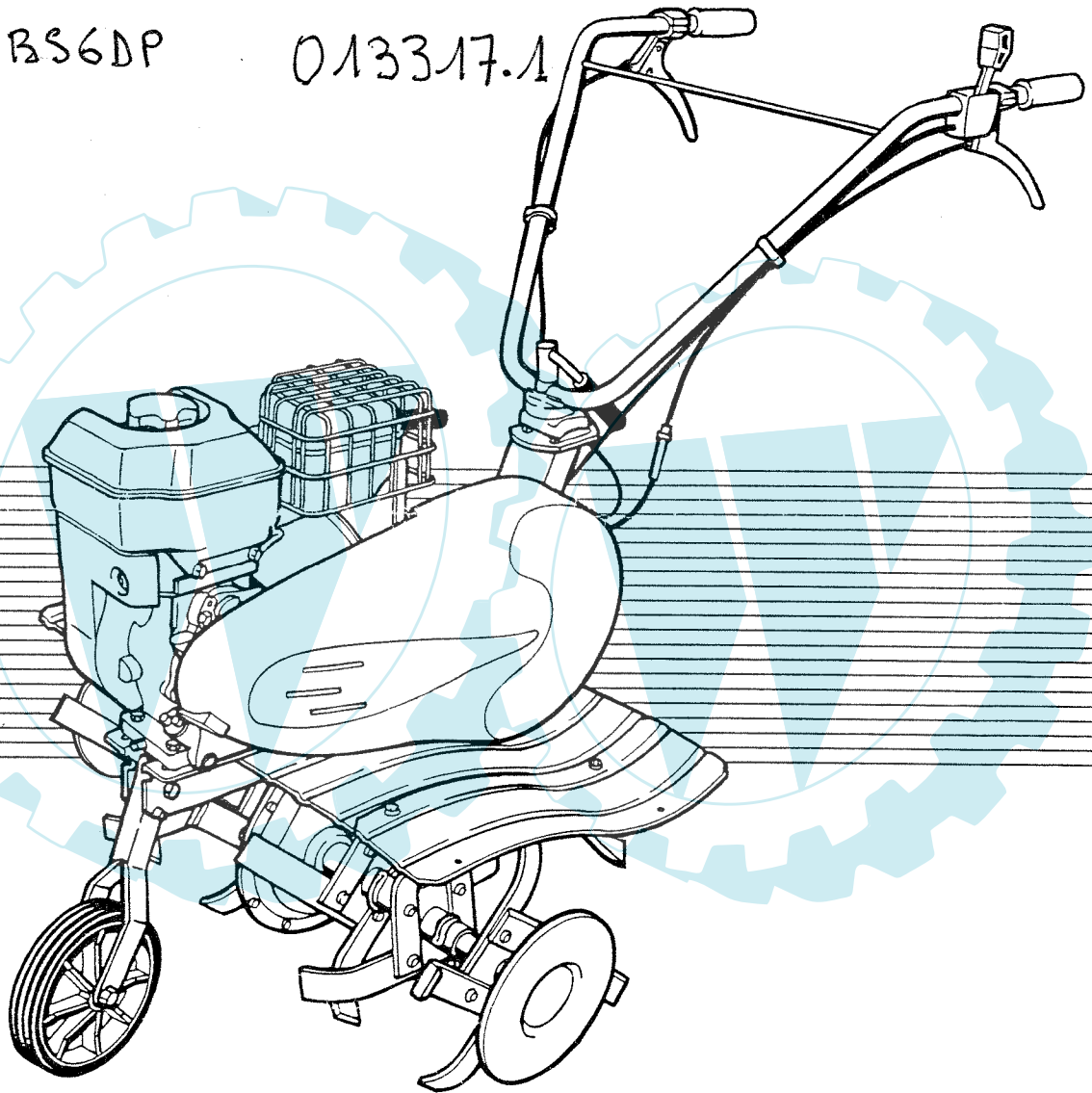

## MOTOBINEUSE

## TILLER

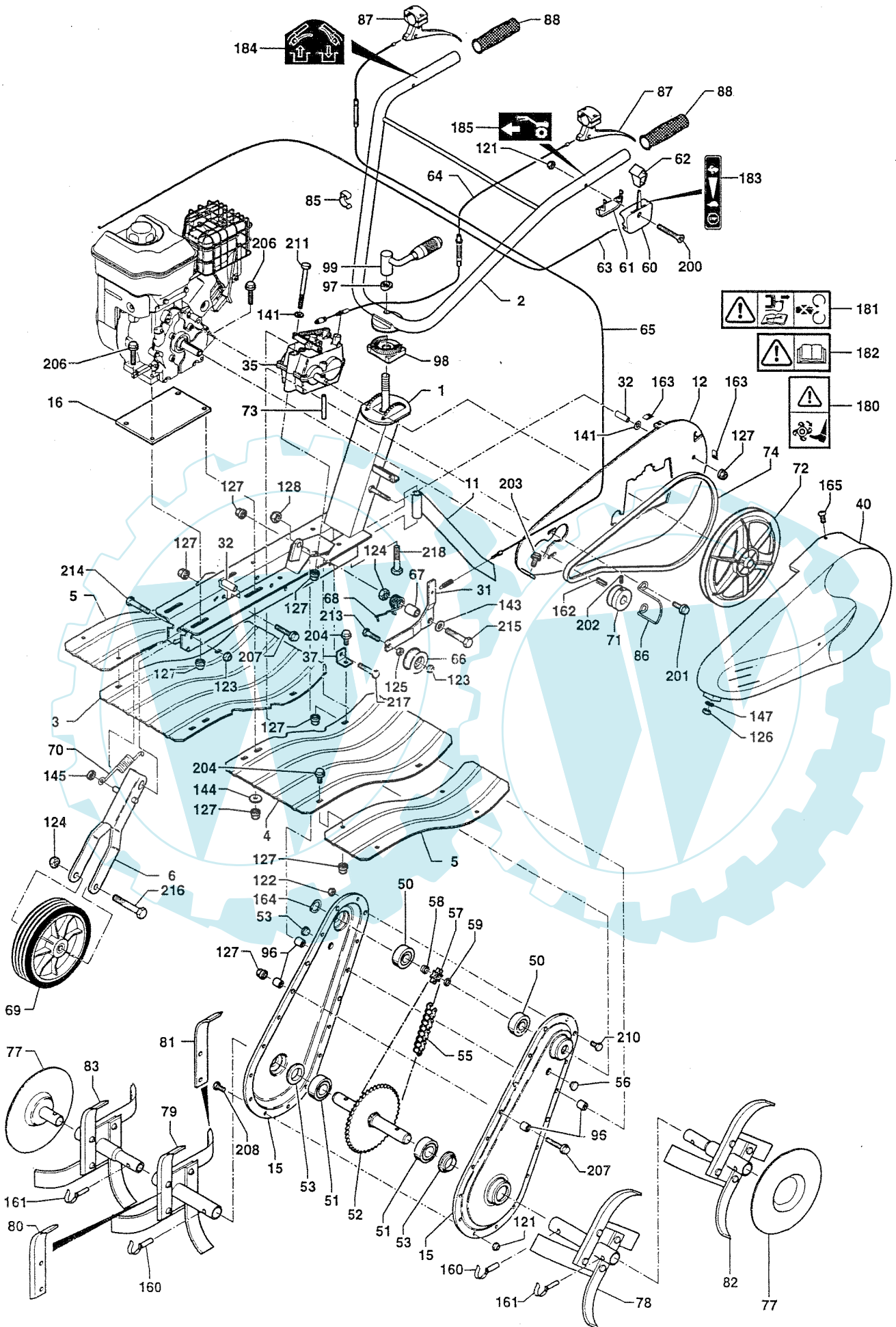

Rep N°	Ref.	Rq Rk	Désignation	Description	Qté Qty
	11302500		Carter complet boulonné (Noir) .....	Complete casing, bolt-together (Black) .....	
1	11532101		Châssis (Jaune 116) .....	Chassis (Yellow 116) .....	1
2	11440103		Guidon (Noir) .....	Handlebars (Black) .....	1
3	11532118		Tôle protection droit (Jaune 116) .....	Right protective cover (Yellow 116) .....	1
4	11532119		Tôle protection gauche (Jaune 116) .....	Left protective cover (Yellow 116) .....	1
5	11532117		Extension tôle protection (Jaune 116) .....	Protective cover guard extension (Yellow 116) .....	2
6	12601005		Supp. roue transport (Noir) .....	Front wheel bracket (Black) .....	1
11	12611011		Éperon (Noir) .....	Key (Black) .....	1
12	11529125		Tôle int capot M.arr. (Noir) .....	Inner stile belt cover (Black) .....	1
16	26501112		Réhausse moteur Robin (Noir) .....	Raising panel Robin (Black) .....	1
31	11701140		Levier embrayage .....	Clutch lever .....	1
32	11301145		Entretoise châssis .....	Spacer .....	2
35	57720996		Réducteur M. ar. mécanique .....	Reversing gearbox .....	1
37	11529145		Patte de fixation tôle .....	Holder .....	2
40	15802		Capot courroie (Noir) .....	Belt cowl (Black) .....	1
50	12503		Roulement .....	Ball-race .....	2
51	12542		Roulement .....	Ball-race .....	2
52	15038		Arbre de travail .....	Blade shaft .....	1
53	46097		Joint de carter .....	Joint .....	2
55	13292		Chaîne .....	Chain .....	1
56	12793		Bouchon .....	Grease cap .....	2
57	13372		Pignon 8 dts .....	Cogwheel .....	1
58	16032		Entretoise épaulée .....	Shouldered spacer .....	1
59	16031		Entretoise carter .....	Spacer .....	1
60	64948		Manette gaz .....	Accelerator lever .....	1
61	62754		Cache manette .....	Accelerator lever housing .....	1
62	68363		Embout manette gaz .....	Accelerator knob .....	1
63	62764		Câble gaz (GC/B.S. 5,5Hp) .....	Throttle cable (GC/B.S. 5,5Hp) .....	1
	13130		Câble gaz (B.S. 3,5Hp) .....	Throttle cable (B.S. 3,5Hp) .....	
	13207		Câble gaz (Robin EY 20) .....	Throttle cable (Robin EY 20) .....	
	13129		Câble gaz (Geotec) .....	Throttle cable (Geotec) .....	
64	13248		Câble inversion vitesse .....	Reverse gear cable .....	1
65	13199		Câble embrayage .....	Clutch cable .....	1
66	12162		Galet embrayage .....	Runner .....	1
67	16034		Entretoise levier embrayage .....	Spacer .....	1
68	65133		Ressort embrayage .....	Spring .....	1
69	14090		Roue avant .....	Front wheel .....	1
70	65026		Ressort roue transport .....	Spring .....	1
71	15415		Poulie moteur M. av-M. ar. arbre Ø19,05 .....	Motor pulley Forward/Reverse gear (Shaft Ø19,05) .....	1
	15432		Poulie moteur M. av-M. ar. arbre Ø20 .....	Motor pulley Forward/Reverse gear (Shaft Ø20) .....	
72	14135		Poulie transmission .....	Transmission pulley .....	1
73	15098		Axe fixation poulie .....	Pulley shaft .....	1
74	13488a		Courroie M. av-M. ar. .....	Forward drive belt .....	1
77	55102		Disque .....	Disk .....	2
78	55201		Étoile départ double 40x4 G .....	Twin rotating blades 40x4 L .....	1
	55098		Étoile départ simple 40x4 G .....	Simple rotating blades 40x4 L .....	
79	55200		Étoile départ double 40x4 D .....	Twin rotating blades 40x4 R .....	1
	55097		Étoile départ simple 40x4 D .....	Simple rotating blades 40x4 R .....	
80	81907		Couteau gauche .....	Blade, LH .....	
81	81906		Couteau droit .....	Blade, RH .....	
82	55150		Étoile addit. dém. gauche .....	Additional blade assembly, LH .....	
83	55103		Étoile addit. dém. droite .....	Additional blade assembly, RH .....	
85	64349		Collier .....	Collar .....	2
86	14989		Guide courroie M. av-M. ar. .....	Drive-belt guide Forward/Reverse gear .....	1
87	62820		Levier .....	Lever .....	2
88	12126		Poignée PVC .....	Grip .....	2
96	16009		Entretoise carter boulonné .....	Spacer .....	4
97	16023		Entretoise poignée de serrage .....	Spacer .....	1
98	36006		Pièce intermédiaire .....	Filler piece .....	1
99	15431		Poignée de serrage .....	Handlebar tightening lever .....	1
121	11482		Écrou frein M6 Z .....	Blocking nut M6 Z .....	
123	11485		Écrou frein M10 Z .....	Blocking nut M10 Z .....	

Rep N°	Ref.	Rq Rk	Désignation	Description	Qté Qty
124	11486		Écrou frein M12 Z .....	Blocking nut M12 Z .....	
125	11429		Écrou H M10 Z .....	Nut H M10 Z .....	
126	11518		Écrou H M6 Z embase crantée .....	Nut H M6 Z, notched shoulder .....	
127	11519		Écrou H M8 Z embase crantée .....	Nut H M8 Z, notched shoulder .....	
128	11521		Écrou H M12 Z embase crantée .....	Nut H M12 Z, notched shoulder .....	
141	11616		Rondelle 8 Z .....	Washer 8 Z .....	
143	11635		Rondelle 12x27x2,5 Z .....	Washer 12x27x2,5 Z .....	
144	11619		Rondelle 9x20x3 Z .....	Washer 9x20x3 Z .....	
145	11818		Rondelle starlock 12 .....	Starlock washer 12 .....	
147	11617		Rondelle 8x30x1,5 Z .....	Washer 8x30x1,5 Z .....	
160	55080		Goupille clips Ø10 .....	Clip pin, 10mm diameter .....	
161	55081		Goupille clips Ø8 .....	Clip pin, 8mm diameter .....	
162	12979		Clavette arbre Ø19,05 .....	Key (Shaft Ø19,05) .....	
	12973		Clavette arbre Ø20 .....	Key (Shaft Ø20) .....	
163	11495		Clips 4,2 .....	Spire nuts 4,2 .....	
164	12855		Circlips .....	Circlips .....	
165	11135		Vis Tôle 4,2 .....	Cover bolt 4,2 .....	
180	14733		Étiq. "Danger fraises" .....	Label: "Danger - rotating blades" .....	
181	14724		Étiq. "Sécurité" .....	Safety label .....	
182	14734		Étiq. "Lire manuel" .....	Label: "Read the manual" .....	
183	64668		Étiquette de gaz + arrêt moteur .....	Label: Accelerator lever + engine cut-off .....	
184	62831		Étiquette embrayage mécanique .....	Label: Clutch lever .....	
185	62830		Étiq. "inversion de vitesse" .....	Label: Forward and reverse gears .....	
200	11176		Vis TF Hc M6x45 Z .....	Screw TF Hc M6x45 Z .....	
201	11113		Vis 5/16 TH24 UNF lg 19 emb crantée .....	Screw 5/16 TH24 UNF lg 19, notched shoulder ..	
202	11085		Vis St Hc M8x16 N .....	Screw St Hc M8x16 N .....	
203	11250		Vis H M6x16 Z embase crantée .....	Screw H M6x16 Z, notched shoulder .....	
204	11260		Vis H M8x16 Z embase crantée .....	Screw H M8x16 Z, notched shoulder .....	
206	11265		Vis H M8x40 Z embase crantée moteur .....	Screw H M8x40 Z, notched shoulder motor .....	
			GC/Briggs/Tecum .....	GC/Briggs/Tecum .....	
	11266		Vis H M8x45 Z embase crantée moteur Robin .....	Screw H M8x45 Z, notched shoulder motor Robin .....	
207	11257		Vis H M8x50 Z embase crantée .....	Screw H M8x50 Z, notched shoulder .....	
208	10750		Vis H M6x12 .....	Screw H M6x12 .....	
210	10766		Vis H M8x16 .....	Screw H M8x16 .....	
211	10794		Vis H M8x110 Z .....	Screw H M8x110 Z .....	
213	10810		Vis H M10x35 Z .....	Screw H M10x35 Z .....	
214	10834		Vis H M10x55 Z .....	Screw H M10x55 Z .....	
215	10859		Vis H M12x60 Z .....	Screw H M12x60 Z .....	
216	10863		Vis H M12x80 Z .....	Screw H M12x80 Z .....	
217	10781		Vis H M8x60 Z .....	Screw H M8x60 Z .....	
218	10899		Vis H M14x90 Z .....	Screw H M14x90 Z .....	